



**Summary**

Parcel Number 17 009400030503  
 Location Address 4555 LAKE FORREST DR  
 SANDY SPRINGS  
 Legal Description  
 Property Class R3 - Residential Lots  
 Neighborhood 1704U  
 Tax District 59  
 Zoning RD18  
 Acres 1.0331  
 Homestead N  
 Exemptions

[View Map](#)

**Owner**

Arslanagic Vedad

**Most Current Owner**

Arslanagic Vedad  
 LAKE FORREST DR  
 ATLANTA GA

Owner Info Last Updated 4/24/2022

**Land**

Description	Land Type	Land Code	Square Feet	Acres
PRIMARY SITE	S	1	45,000	1.0331

Total Acres:  
1.0331

**Residential Improvement Information**

Card 1  
 Stories 2  
 Exterior Wall BRICK  
 Style CONVENTIONAL  
 Year Built 2015  
 Effective Age 0  
 Res Sq Ft 5546  
 Basement FULL  
 Finished Bsmt Sqft 2600  
 Full Bath/Half Bath 5/1  
 Bedrooms 5  
 Attic UNFIN  
 Additional Fixtures 15

Heating System WARM AIR  
 Heat CENTRAL WITH A/C  
 Total Fixtures 32  
 Masonry Fireplaces 2  
 Heating Fuel Type GAS  
 Pre Fab Fireplace 0  
 Miscellaneous Feature  
 Miscellaneous Feature 2  
 Grade Factor X+ 2.5  
 Cost/Design Factor 0%  
 CDU VG

**Accessory Information**

Description	Year Built	Area
WOOD DECK	2015	720
POOL GUNI	2015	792

Sales

Sale Date	Sale Price	Instrument	Deed Book	Deed Page	Qualification	Sales Validity
12/30/2015	\$1,645,000		55738	0261	Qualified	Valid Sale
1/16/2015	\$0		54552	0472	Unqualified	Sale < = 1000
1/16/2015	\$535,000		54552	0471	Qualified	Valid Sale
7/25/2003	\$0	QC	36166	00372	Unqualified	Related Individuals or Corporation
1/22/1986	\$100,050		09932	00330	Unqualified	Not Typical of Market Conditions

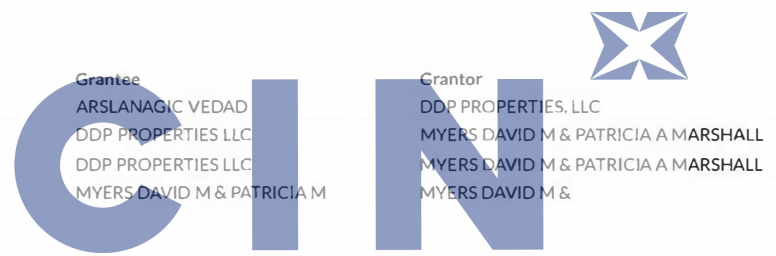

Grantee  
ARSLANAGIC VEDAD  
DDP PROPERTIES LLC  
DDP PROPERTIES LLC  
MYERS DAVID M & PATRICIA M

Grantor  
DDP PROPERTIES, LLC  
MYERS DAVID M & PATRICIA A MARSHALL  
MYERS DAVID M & PATRICIA A MARSHALL  
MYERS DAVID M &

Recording
55738 0261
54552 0472
54552 0471
36166 00372
09932 00330

Valuation

	2023	2022	2021	2020	2019	2018
LUC	101	101	101	101	101	101
Class	R3	R3	R3	R3	R3	R3
+ Land Value	\$427,000	\$629,600	\$611,200	\$273,000	\$330,200	\$322,500
+ Building Value	\$2,059,700	\$643,500	\$624,700	\$973,500	\$760,500	\$739,300
= Total Value	\$2,486,700	\$1,273,100	\$1,235,900	\$1,246,500	\$1,090,700	\$1,061,800
Assessed Value	\$994,680	\$509,240	\$494,360	\$498,600	\$436,280	\$424,720

Assessment Notices

[2023 Assessment Notice \(PDF\)](#)

Sketches



Room Type	Area
A Base Area	2136
B 1SMAS MASONRY	1135
C MG/BG MASONRY/BRICK GARAGE	594
D Base Area	252
E MG/BG MASONRY/BRICK GARAGE	220
F 1SMAS MASONRY	216
G OMP OPEN MASONRY PORCH	40
H OMP OPEN MASONRY PORCH	36
I MABAY MASONRY BAY	20

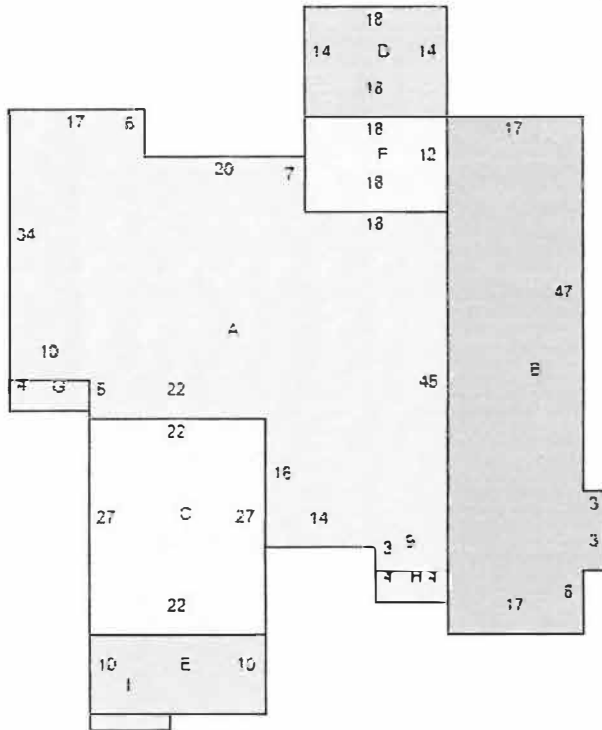

No data available for the following modules: Comp Search (Commercial), Comp Search (Vacant), Summary - Personal Property, Commercial Improvement Information, Appraised Values - Personal Property.

The Fulton County Board of Assessors makes every effort to produce the most accurate information possible. No warranties, expressed or implied, are provided for the data herein, its use or interpretation. The assessment information is from the last certified tax roll. All other data is subject to change.

[User Privacy Policy](#) | [GDPR Privacy Notice](#)  
 Last Data Upload: 7/24/2023, 12:02:33 PM

Contact Us